

Q-280

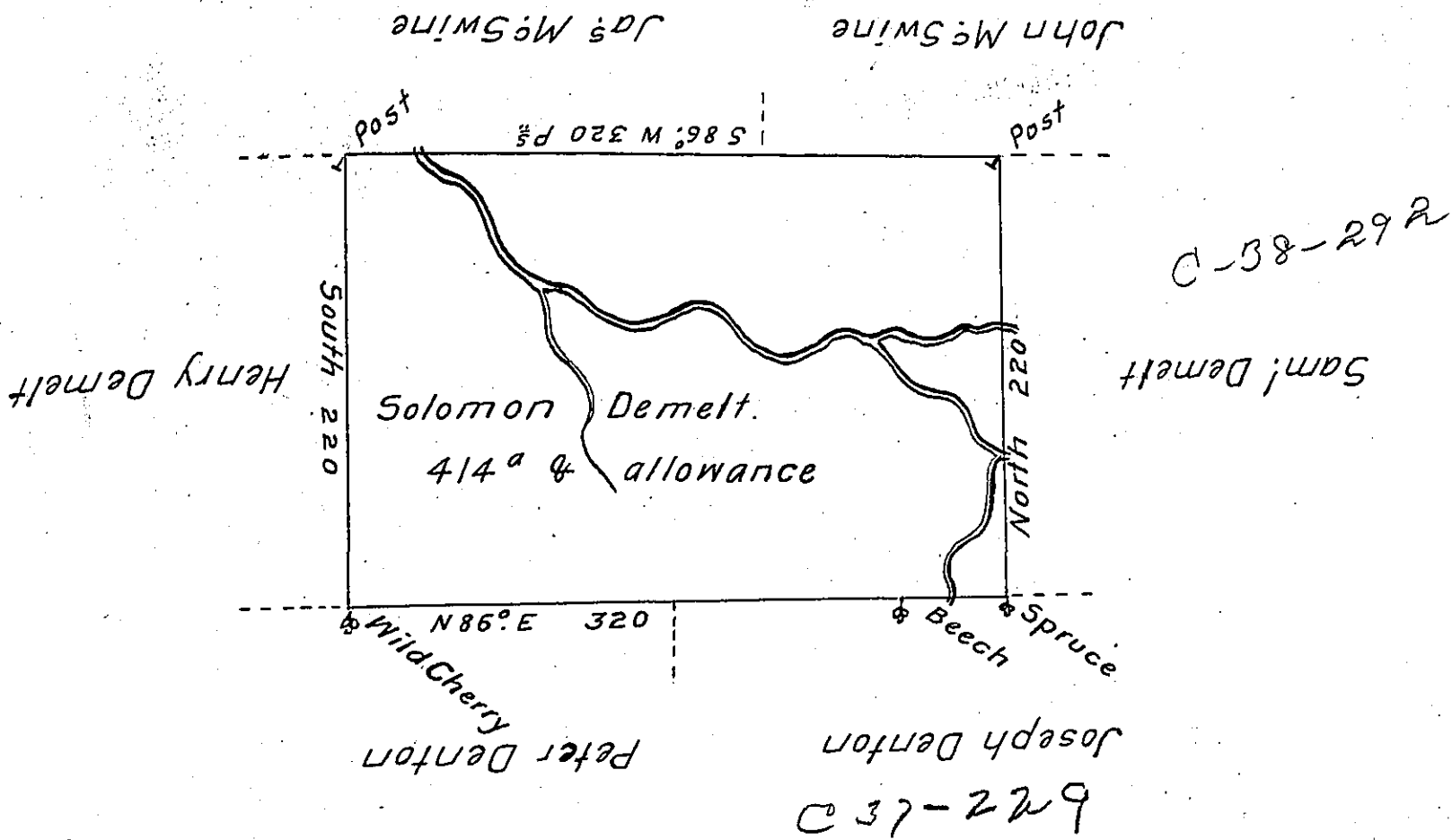

A Draught of a Tract of Land Called _____ Situate on the Waters
of Choconut Creek, Adjoining Land of Samuel Demelt, and others in
Stoke Township Northumberland County, Surveyed on the 28th day of
April 1785 for Solomon Demelt, by Virtue of his Warrant dated the
4th day of April 1785. Containing four Hundred and fourteen Acres
and allowance of Six P C! for Roads &c ~ by

To John Lukens Esq' }
Surveyor Gen! }

W^m Gray D.S.

IN TESTIMONY that the above is a copy of the original remaining on file in
the Department of Internal Affairs of Pennsylvania, made
conformably to an Act of Assembly approved the 16th day of
February, 1833, I have hereunto set my Hand and caused
the Seal of said Department to be affixed at Harrisburg,
this thirtieth day of July 1904

James R. Brown
Secretary of Internal Affairs.